

"I, MARK SHAW being a certified / registered engineer and duly authorised representative of KN GROUP PTY LTD hereby -

- × Certify the information contained in this drawing is an accurate "AS CONSTRUCTED" representation of the works.
- × Accept responsibility for the "AS CONSTRUCTED" information contained in this drawing.
- × Acknowledge the "AS CONSTRUCTED" information contained in the drawing may be relied on by Council and others.

Certification for Stage ..... by ..... on .....

for KN GROUP PTY LTD.

Registered Professional Engineer of Queensland - No. 17544

We RPS Australia East Pty Ltd, Registered Surveyor - Land hereby certify that the Levels and Dimensions shown hereon are a correct record of our Survey which was performed in accordance with Council Accuracy Standards

  
 Authorised Delegate

13/09/2017  
 Date

**LEGEND**

- Post Construction Contours
- Topographic Change In Grade
- Post Construction Surface Level
- Concrete Path or Driveway
- Back of Kerb and Channel
- Edge of Bitumen

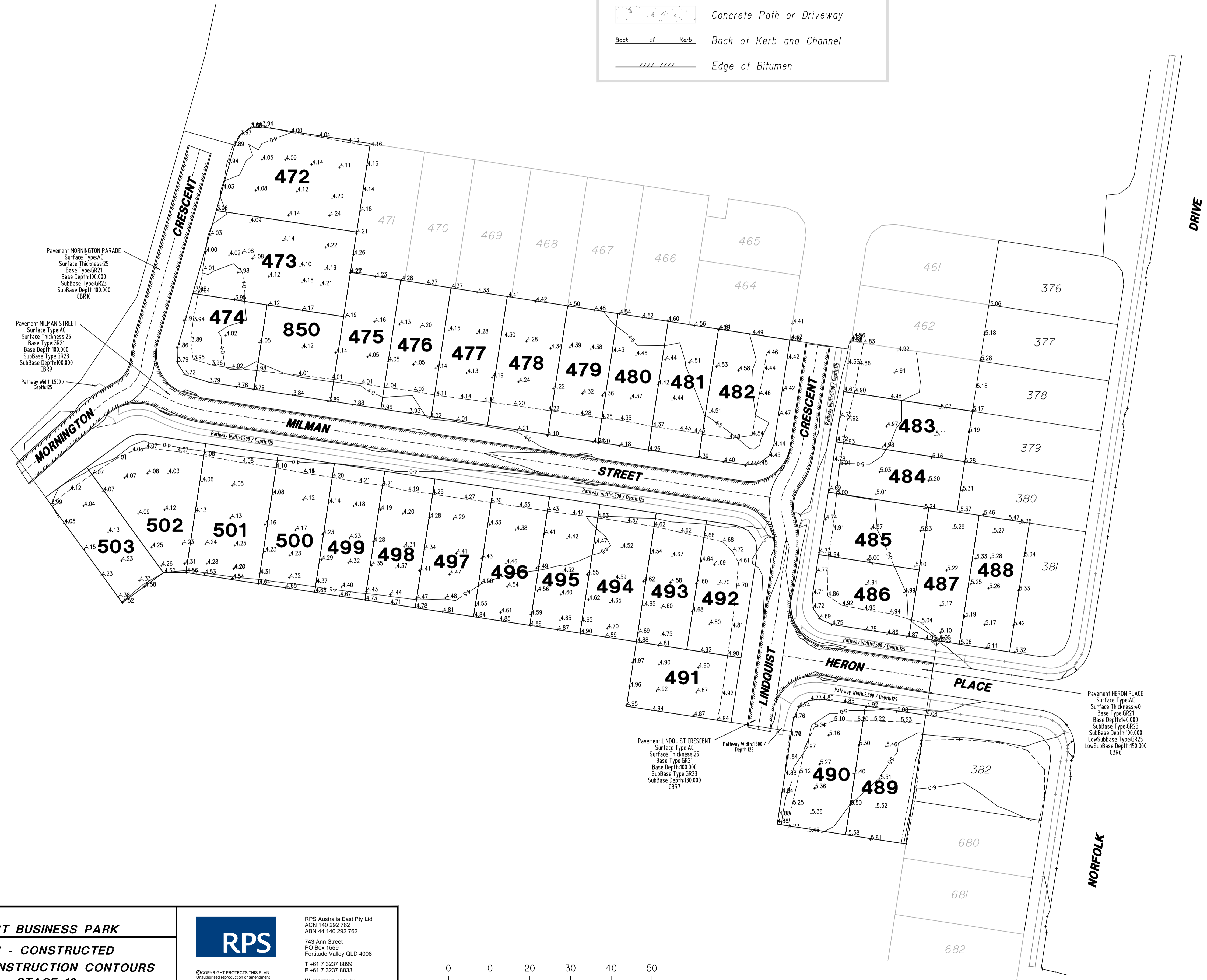
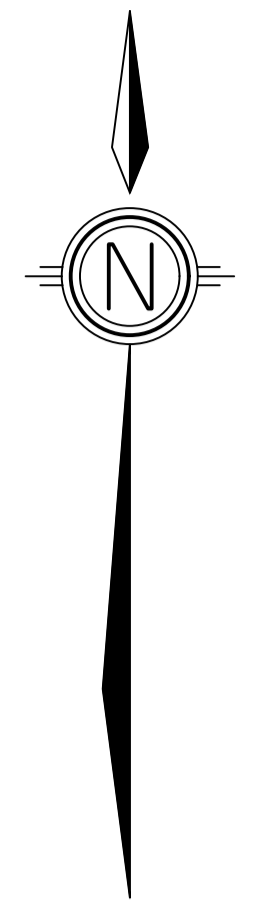

<b>PROJECT</b> NORTH HARBOUR		<b>CLIENT</b> NORTHEAST BUSINESS PARK	
<b>LEVEL DATUM</b> AHD	<b>SCALE</b> 1:500 @ A1	<b>AS - CONSTRUCTED</b>	
<b>ORIGIN</b> PM 72418 RL 14-859 CNR BUCKLEY & COBB RDS	<b>Date</b> SEPT 2017 <b>Surveyed</b> RPS	<b>POST CONSTRUCTION CONTOURS</b>	
<b>FB : SDR</b> <b>LB :</b>	<b>Comp by</b> AJH/KCH	<b>Parish</b> REDCLIFFE	<b>Job Ref</b>
<b>DWG Name</b> 20430-Stage16-Post	<b>Local Authority</b> MORETON BAY REGIONAL COUNCIL	<b>Reference</b> 20430-200	<b>Rev</b>

**RPS**  
 RPS Australia East Pty Ltd  
 ACN 140 292 762  
 ABN 44 140 292 762  
 743 Ann Street  
 PO Box 1659  
 Fortitude Valley QLD 4006  
 T +61 7 3237 8899  
 F +61 7 3237 8833  
 W rpsgroup.com.au

