

HARVEST PARK

Harvest Park is now open!

Located alongside part of North Harbour's extensive environmental corridor it includes BBQ facilities, picnic shelter, walking and bike paths, fitness equipment, table tennis table, sunlounges and our first edible garden.



EDIBLE GARDEN







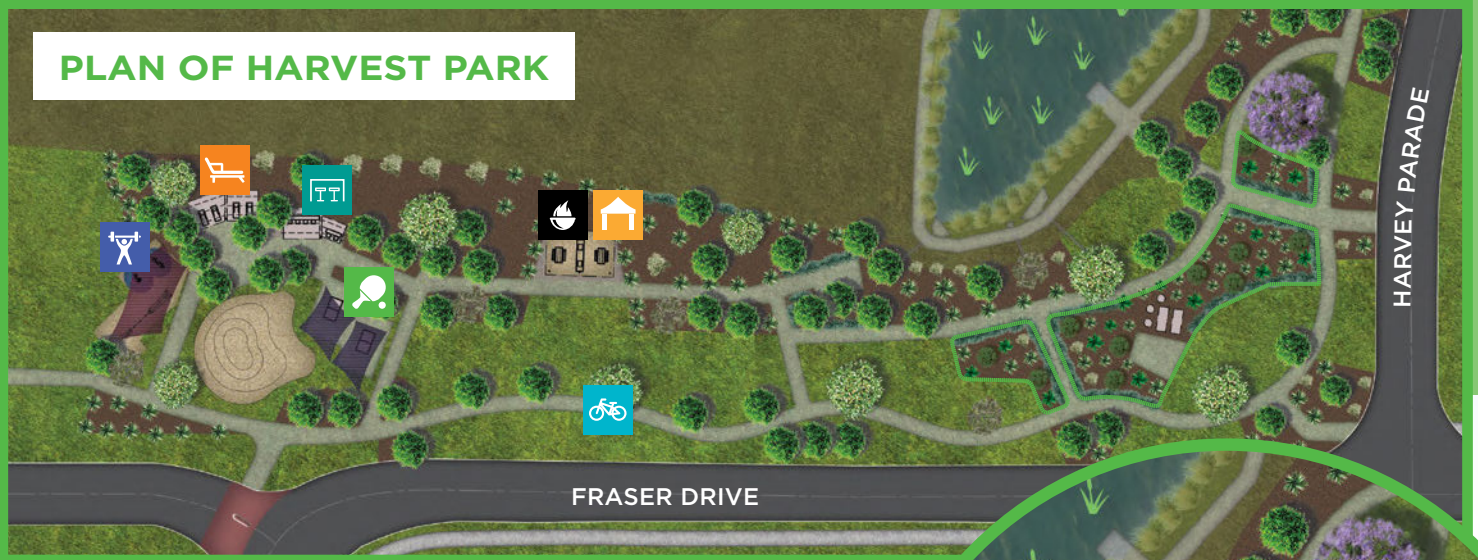

Harvest Park's edible garden includes a range of fruit trees including lime, lemon and avocado and plants such as capsicum, lemongrass, passionfruit and herbs. The garden allows space to wander through the trees and garden beds, each area is labelled so you can see what you're eating.

The idea behind the edible garden is to encourage our local community to enjoy the beauty and bounty of nature and to work together to nurture the garden. Hence the name "Harvest Park". We're sure our North Harbour families will love picnicking in this beautiful spot for years to come.

PLAN OF HARVEST PARK



PARK KEY

- | | | | | | |
|--|--|---|-------------------|---|---------------|
|  | Barbeque Facilities |  | Bicycle Path |  | Breakfast Bar |
|  | Picnic Shelter |  | Fitness Equipment |  | Wetlands |
|  | Sun Lounges |  | Table Tennis | | |
|  | Edible Garden - range of edible options including limes, lemons, capsicums, avocados, lemongrass, passionfruit, figs and more. | | | | |

EDIBLE GARDEN