



UNITYWATER PROJECT NUMBER 2016009402S31

Stage 31, North Harbour Estate

WATER MAIN AS CONSTRUCTED



DRAWING INDEX	
DRAWING NUMBER	DESCRIPTION
U-2022-4277	LOCALITY PLAN AND DRAWING INDEX

COORDINATE DATUM NOTE:
 HORIZONTAL COORDINATES(E,N) SUPPLIED ARE MAPPING GRID OF AUSTRALIA(MGA), ZONE 56 BASED ON THE UNIVERSAL TRANSVERSE MERCATOR PROJECTION AND THE GEOCENTRIC DATUM OF AUSTRALIA 1994.

ENGINEER'S CERTIFICATION

I, Mark Shaw, of KN GROUP PTY LTD, hereby certify that:
 1. The information contained in this drawing / document is in compliance with approved drawings and design.
 2. The new water and sewerage works defined by this drawing have been designed and constructed in accordance with the SEQ Code.
 3. This represents an accurate record of as-constructed works
 4. I accept responsibility for the information contained in this drawing / document.

M Shaw Mark Andrew Shaw BEng
 Civil, MEA/Asst. 89162 17544
 2022/02/03 15:25:23 +10:00
 RPEQ (signature) RPEQ No. 17544 Date:

REGISTERED SURVEYOR'S CERTIFICATION

We, T.H. JENSEN BOWERS PTY LTD, hereby certify that the vertical and horizontal locations and dimensions shown on this plan are a true and correct record and were located by survey.

T.H. Jensen
 Registered Surveyor (sig) Reg. Surveyor No. 3756 Date: 02/03/23

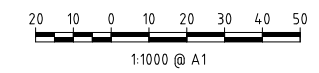

AS CONSTRUCTED

A1	INDEX	DATE	Original Issue	DRAWN	CHECKED	PASSED	INITIALS	DATE		Unitywater 2016009402S31 North Harbour Stage 31	SHEET 1 OF 2 SHEETS	SCALE 1:1000
											REVISION DATE 10-11-2022	REVISION A
											DISCIPLINE CODE C	DRAWING NO. U-2022-4277

LEGEND

- ∅ Pipe Diameter
- Fire Hydrant
- Temporary Hydrant/End
- ⊗ Valve
- ① 11.25° BEND
- ② 22.5° BEND
- ③ 45° BEND
- ④ 90° BEND
- ⊕ Ready Tap
- Water Meter
- Water Crossing
- Water Main
- ==== DICT Water Main Easement

NOTES

- Water main pipes are Ø150 PVC-0 Class PN16 unless noted otherwise.
- All road crossings are Ø150 DICT Class DN35 unless noted otherwise.
- All water services are DN25 PE100 PN16.
- Unity Water to Install Meter on Existing Ball Valve for Lot 333 & 351

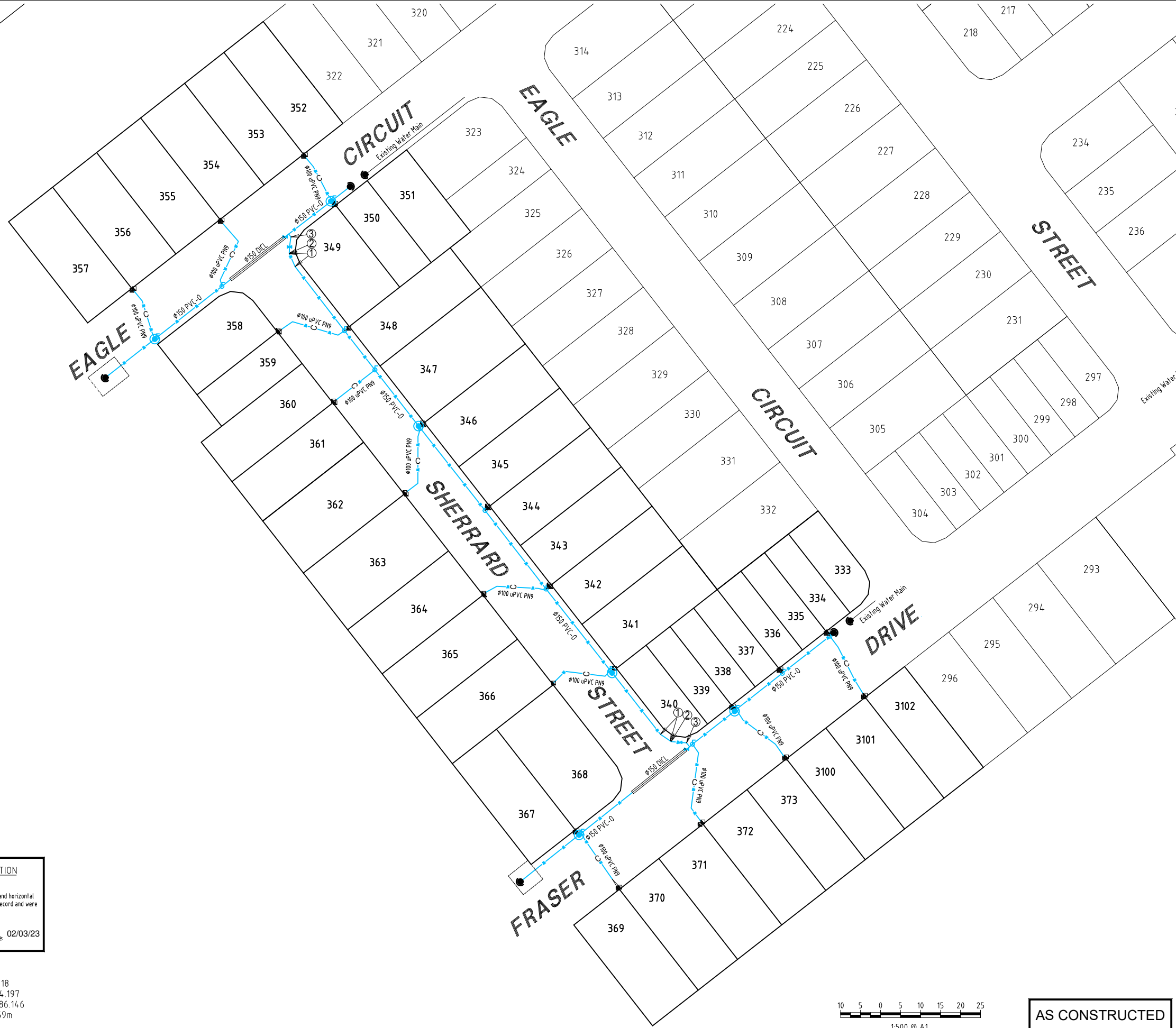

ENGINEER'S CERTIFICATION

I, Mark Shaw, of KN GROUP PTY LTD, hereby certify that:
 1. The information contained in this drawing / document is in compliance with approved drawings and design.
 2. The new water and sewerage works defined by this drawing have been designed and constructed in accordance with the SEQ Code.
 3. This represents an accurate record of as-constructed works.
 4. I accept responsibility for the information contained in this drawing / document.

M. Shaw
 Mark Andrew Shaw BEng
 ICAN, MRSA, RP02 17544
 2022/03 15:25:36 +10:00
 RPEQ (signature) RPEQ No. 17544 Date:

REGISTERED SURVEYOR'S CERTIFICATION

We, T.H. JENSEN BOWERS PTY LTD, hereby certify that the vertical and horizontal locations and dimensions shown on this plan are a true and correct record and were located by survey.

T.H. Jensen
 Registered Surveyor (sig) Reg. Surveyor No. 3756 Date: 02/03/23

COORDINATE DATUM NOTE:

HORIZONTAL COORDINATES (E, N) SUPPLIED ARE MAPPING GRID OF AUSTRALIA (MGA), ZONE 56 BASED ON THE UNIVERSAL TRANSVERSE MERCATOR PROJECTION AND THE GEOCENTRIC DATUM OF AUSTRALIA 1994.

PSM 724.18
 E: 498714.197
 N: 6999186.146
 RL: 14.859m

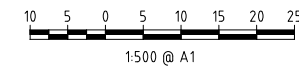

AS CONSTRUCTED

A1

INDEX	DATE	REVISIONS	DRAWN	CHECKED	PASSED
A	10/11/2022	Original Issue	JB	SJM	DB

DRAWN	CHECKED	PASSED	INITIALS	DATE
JB	SJM	DB		10/11/2022
				10/11/2022

72 Costin Street, Fortitude Valley, Qld. 4006
 PO Box 799, Spring Hill, Qld. 4004
 T: (07) 3852 1771 F: (07) 3229 6818
 T.H. Jensen & Bowers Pty. Ltd. (Consulting Surveyors)
 Sols. 52 012 812 827

JENSEN BOWERS

SURVEYORS
 PLANNERS
 DEVELOPMENT ADVISORS
 jensenbowers.com.au

kn group

KN IS THE SEQ
 LEAD GROUP FOR
 WATER AND
 SEWERAGE
 SERVICES

Unitywater

Unitywater

20160094.02531
 North Harbour Stage 31

SHEET 2 OF 2 SHEETS	SCALE 1:500
REVISION DATE 10-11-2022	REVISION A
DISCIPLINE CODE C	
DRAWING NO. U-2022-4277	