

PSM 724.18
 E: 498714.197
 N: 6999186.146
 RL: 14.859m



UNITYWATER PROJECT NUMBER 2016009402S32

Stage 32, North Harbour Estate

SEWER MAIN AS CONSTRUCTED



DRAWING INDEX	
DRAWING NUMBER	DESCRIPTION
U-2022-4383	LOCALITY PLAN AND DRAWING INDEX

COORDINATE DATUM NOTE:
 HORIZONTAL COORDINATES(E,N) SUPPLIED ARE MAPPING GRID OF AUSTRALIA(MGA), ZONE 56 BASED ON THE UNIVERSAL TRANSVERSE MERCATOR PROJECTION AND THE GEOCENTRIC DATUM OF AUSTRALIA 1994.

ENGINEER'S CERTIFICATION

I, Mark Shaw, of KN GROUP PTY LTD, hereby certify that:
 1. The information contained in this drawing / document is in compliance with approved drawings and design.
 2. The new water and sewerage works defined by this drawing have been designed and constructed in accordance with the SEQ Code.
 3. This represents an accurate record of as-constructed works
 4. I accept responsibility for the information contained in this drawing / document.

M. Shaw
 Mark Andrew Shaw BEng
 CIVIL ENGINEER (RPEQ) 17444
 2023/04/28 16:39:04 +10:00
 RPEQ (signature) RPEQ No. 17544 Date:

REGISTERED SURVEYOR'S CERTIFICATION

We, T.H. JENSEN BOWERS PTY LTD, hereby certify that the vertical and horizontal locations and dimensions shown on this plan are a true and correct record and were located by survey.

T.H. Jensen
 Registered Surveyor (sig) Reg. Surveyor No. 3756 Date: 28/04/23

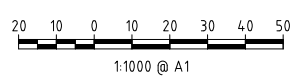

AS CONSTRUCTED

A1	INDEX	DATE	REVISIONS
	A	11/04/2023	Original Issue

DRAWN	JB	11/04/2023
CHECKED	SJM	11/04/2023
PASSED	DB	11/04/2023
INITIALS		DATE

JENSEN BOWERS
 72 Cosin Street, Fortitude Valley, Qld. 4006
 PO Box 709, Spring Hill, Qld. 4004
 T (07) 3852 1771 F (07) 3252 9818
 T.H. Jensen & Bowers Pty. Ltd. (Consulting Surveyors)
 MBS 62 618 817 807
 Copyright reserved to Jensen Bowers Group Consultancy Pty Ltd
 SURVEYORS
 PLANNERS
 DEVELOPMENT ADVISORS
 jensenbowers.com.au

kn group
 100-102 123 011
 55, 62 and 64
 North Quay
 Brisbane QLD 4000
 07 3807 8900
 www.kn.com.au

Unitywater

Unitywater

2016009402S32
 North Harbour Stage 32

SHEET 1 OF 2 SHEETS	SCALE 1:1000
REVISION DATE 09-05-2022	REVISION A
DISCIPLINE CODE C	
DRAWING NO. U-2022-4383	

NOTES

- All Sewer Main Pipes are DN160 PE100 SDR21 PN8, White Wall.
- All Sewer House Connections are DN110 PE100 SDR21 PN8, White Wall.

LEGEND

- x Pipe Size Change from DN160 to DN110
- Y DN160/110 45 Degree Junction
- Easement Line

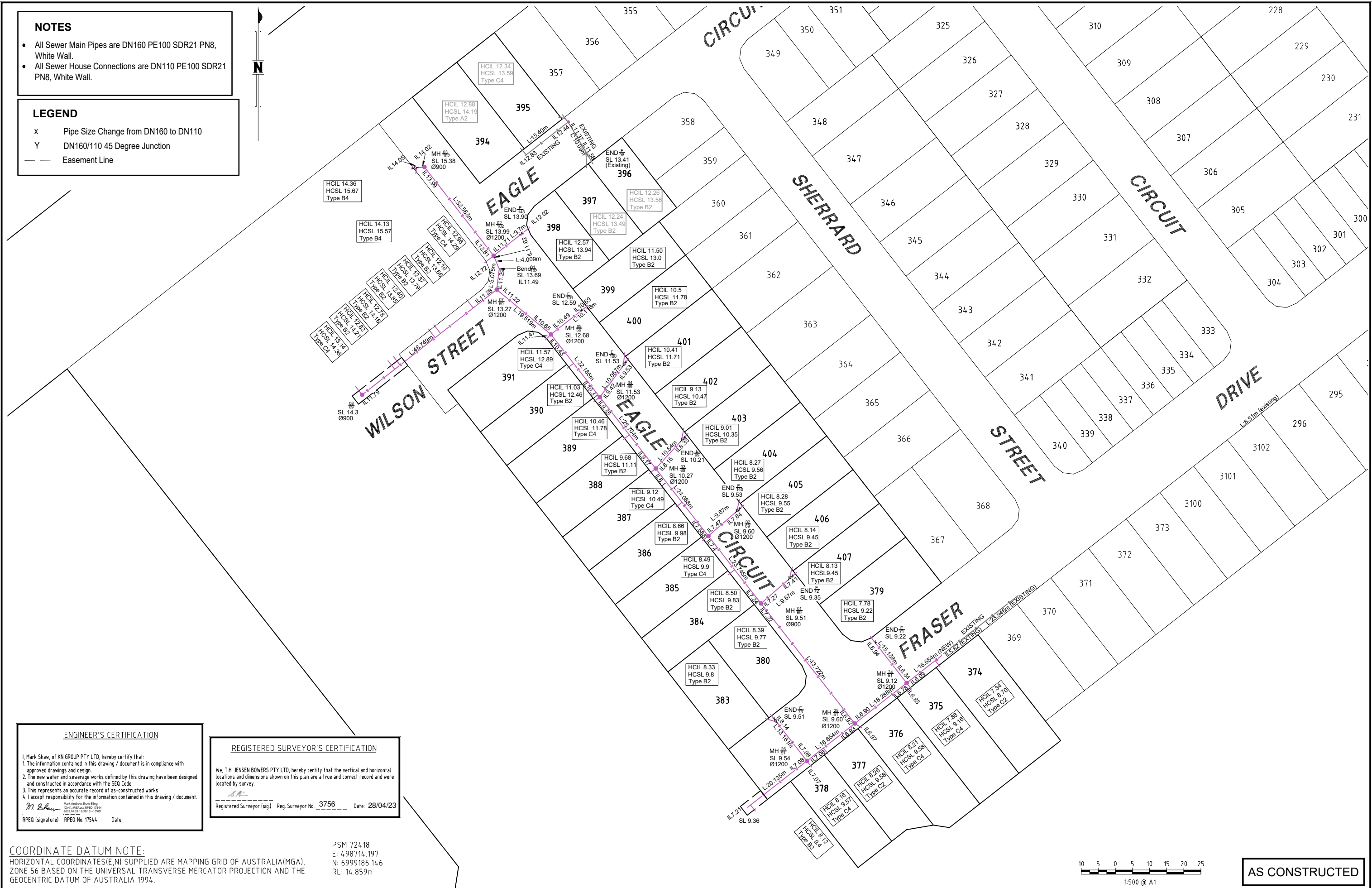

ENGINEER'S CERTIFICATION

I, Mark Shaw, of KN GROUP PTY LTD, hereby certify that:
 1. The information contained in this drawing / document is in compliance with approved drawings and design.
 2. The new water and sewerage works defined by this drawing have been designed and constructed in accordance with the SEQ Code.
 3. This represents an accurate record of as-constructed works.
 4. I accept responsibility for the information contained in this drawing / document.

M. Shaw
 Mark Andrew Shaw (sig)
 RPEQ (signature) RPEQ No. 17544 Date: _____

REGISTERED SURVEYOR'S CERTIFICATION

We, T.H. JENSEN BOWERS PTY LTD, hereby certify that the vertical and horizontal locations and dimensions shown on this plan are a true and correct record and were located by survey.

T.H. Jensen
 Registered Surveyor (sig) Reg. Surveyor No. 3756 Date: 28/04/23

COORDINATE DATUM NOTE:

HORIZONTAL COORDINATES(E,N) SUPPLIED ARE MAPPING GRID OF AUSTRALIA(MGA), ZONE 56 BASED ON THE UNIVERSAL TRANSVERSE MERCATOR PROJECTION AND THE GEOCENTRIC DATUM OF AUSTRALIA 1994.

PSM 724.18
 E: 498714.197
 N: 6999186.146
 RL: 14.859m

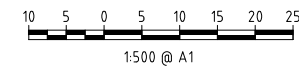

AS CONSTRUCTED

A1

INDEX	DATE	REVISIONS	DRAWN	CHECKED	PASSED	INITIALS	DATE
A	09/05/2022	Original Issue	JB	SJM	DB		

DRAWN	JB	09/05/2022
CHECKED	SJM	09/05/2022
PASSED	DB	09/05/2022

Unitywater
 2016009402532
 North Harbour Stage 32

SHEET 2 OF 2 SHEETS	SCALE 1:500
REVISION DATE 11-04-2023	REVISION A
DISCIPLINE CODE C	
DRAWING NO. U-2022-4383	