

PSM 724.18
 E: 498714.197
 N: 6999186.146
 RL: 14.859m



UNITYWATER PROJECT NUMBER 2016009402S32

Stage 32, North Harbour Estate

WATER MAIN AS CONSTUCTED



DRAWING INDEX	
DRAWING NUMBER	DESCRIPTION
U-2022-4383	LOCALITY PLAN AND DRAWING INDEX

COORDINATE DATUM NOTE:
 HORIZONTAL COORDINATES(E,N) SUPPLIED ARE MAPPING GRID OF AUSTRALIA(MGA), ZONE 56 BASED ON THE UNIVERSAL TRANSVERSE MERCATOR PROJECTION AND THE GEOCENTRIC DATUM OF AUSTRALIA 1994.

ENGINEER'S CERTIFICATION

I, Mark Shaw, of KN GROUP PTY LTD, hereby certify that:
 1. The information contained in this drawing / document is in compliance with approved drawings and design.
 2. The new water and sewerage works defined by this drawing have been designed and constructed in accordance with the SEQ Code.
 3. This represents an accurate record of as-constructed works
 4. I accept responsibility for the information contained in this drawing / document.

M. Shaw
 Mark Andrew Shaw (Eng. Reg. No. 17544)
 RPEQ (signature) RPEQ No. 17544 Date: _____

REGISTERED SURVEYOR'S CERTIFICATION

We, T.H. JENSEN BOWERS PTY LTD, hereby certify that the vertical and horizontal locations and dimensions shown on this plan are a true and correct record and were located by survey.

T.H. Jensen
 Registered Surveyor (sig) Reg. Surveyor No. 3756 Date: 28/04/23

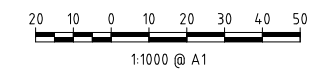

AS CONSTRUCTED

A1	INDEX	DATE	REVISIONS	DRAWN	CHECKED	PASSED	INITIALS	DATE		Unitywater 2016009402S32 North Harbour Stage 32	SHEET 1 OF 2 SHEETS	SCALE 1:1000
	A	11/04/2023	Original Issue	JB	SJM	DB		11/04/2023				REVISION A

LEGEND

- ∅ Pipe Diameter
- Fire Hydrant
- Temporary Hydrant/End
- ⊗ Valve
- ① 11.25° BEND
- ② 22.5° BEND
- ③ 45° BEND
- ④ 90° BEND
- ⑤ 150 X 150 X 150 TEE
- ⊕ Ready Tap
- ⊖ Water Meter
- Water Crossing
- Water Main
- DICI Water Main
- Easement

NOTES

- Water main pipes are Ø150 PVC-0 Class PN16 unless noted otherwise.
- All road crossings are Ø150 DICI Class DN35 unless noted otherwise.
- All water services are DN25 PE100 PN16.
- Unity Water to install Meter on Existing Ball Valve for Lot 396

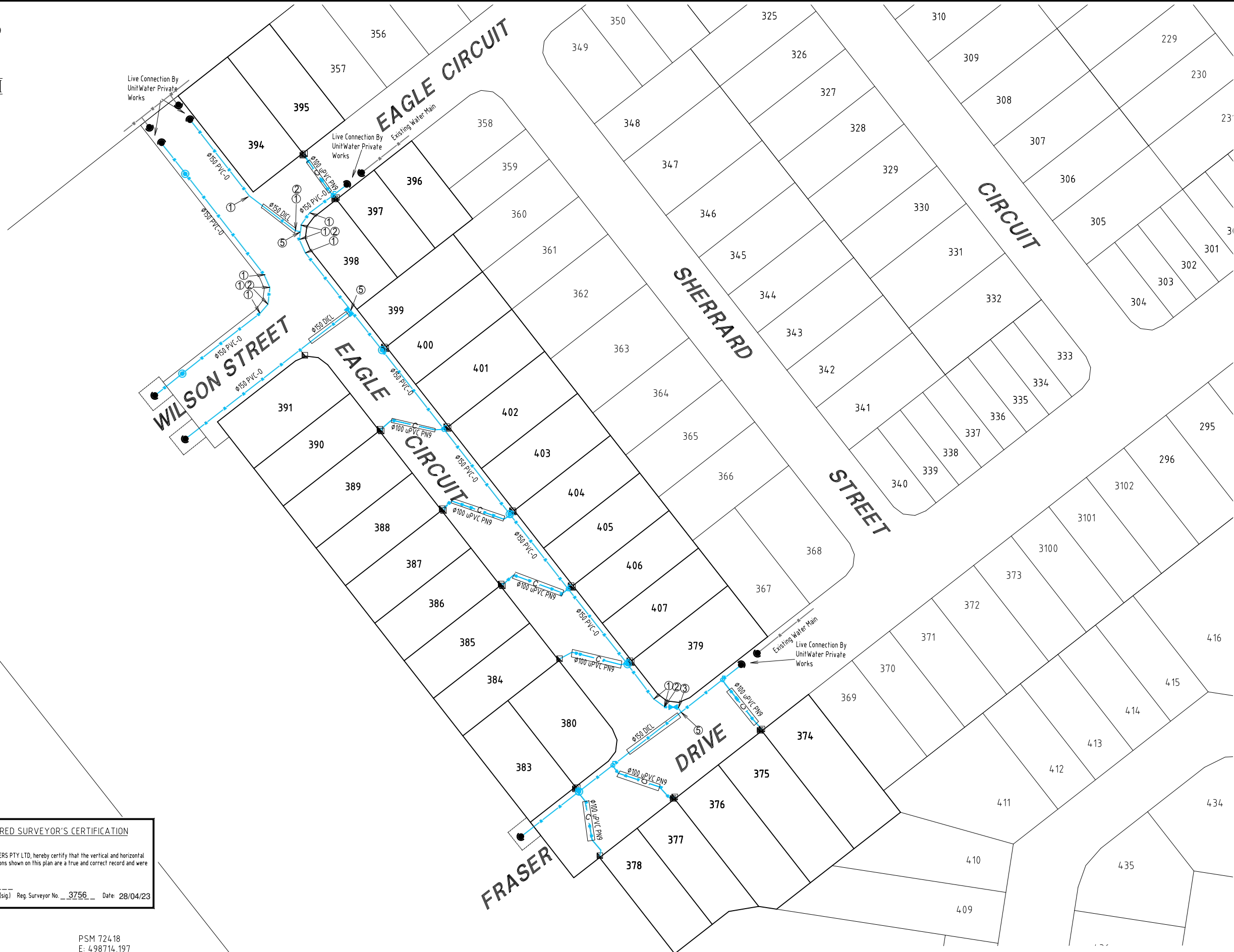

ENGINEER'S CERTIFICATION

I, Mark Shaw, of KN GROUP PTY LTD, hereby certify that:
 1. The information contained in this drawing / document is in compliance with approved drawings and design.
 2. The new water and sewerage works defined by this drawing have been designed and constructed in accordance with the SEQ Code.
 3. This represents an accurate record of as-constructed works.
 4. I accept responsibility for the information contained in this drawing / document.

M. Shaw
 Mark Andrew Shaw 8879
 (048) 888888 RPEQ 17544
 2023_04_28 16:39:51 +10:00
 RPEQ (signature) RPEQ No. 17544 Date:

REGISTERED SURVEYOR'S CERTIFICATION

We, T.H. JENSEN BOWERS PTY LTD, hereby certify that the vertical and horizontal locations and dimensions shown on this plan are a true and correct record and were located by survey.

T.H. Jensen
 Registered Surveyor (sig) Reg. Surveyor No. 3756 Date: 28/04/23

COORDINATE DATUM NOTE:
 HORIZONTAL COORDINATES(E,N) SUPPLIED ARE MAPPING GRID OF AUSTRALIA(MGA), ZONE 56 BASED ON THE UNIVERSAL TRANSVERSE MERCATOR PROJECTION AND THE GEOCENTRIC DATUM OF AUSTRALIA 1994.

PSM 724.18
 E: 498714.197
 N: 6999186.146
 RL: 14.859m

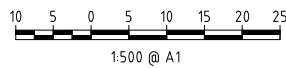

AS CONSTRUCTED

A1

INDEX	DATE	REVISIONS	DRAWN	CHECKED	PASSED	INITIALS	DATE
A	30/10/2022	Original Issue	JB	SJM	DB		30/10/2022

DRAWN	JB	30/10/2022
CHECKED	SJM	30/10/2022
PASSED	DB	30/10/2022

72 Cochin Street, Fortitude Valley, Qld. 4006
 PO Box 799, Spring Hill, Qld. 4004
 T: (07) 3822 1771 F: (07) 3252 0818
 T.H. Jensen & Bowers Pty. Ltd. (Consulting Surveyors)
 ABN: 52 619 812 607

JENSEN BOWERS
 SURVEYORS
 PLANNERS
 DEVELOPMENT ADVISORS
 jensenbowers.com.au

KN Group
 11.02.2022 11:52
 11.02.2022 11:52
 11.02.2022 11:52

Unitywater

Unitywater

2016009402532
 North Harbour Stage 32

SHEET 2 OF 2 SHEETS	SCALE 1:500
REVISION DATE 30-10-2022	REVISION A
DISCIPLINE CODE C	
DRAWING NO. U-2022-4383	